

# Visualising indicative density and development - Northern Corridor

## Taupiri / Ngaarauwaahia / Hopuhopu

Medium density residential within Metro Centre, supported by Rapid and Frequent Transit



Net density: 40-50 dwellings per hectare



Net density: 30-40 dwellings per hectare



Mixed-use development

## Horotiu

Low density residential within Town Centre, supported by Rapid Transit



Net density: 25-35 dwellings per hectare



Net density: 15-25 dwellings per hectare



Net density: 20-30 dwellings per hectare

## Te Rapa

Medium-high density residential within Metro Centre, key employment hub and supported by Rapid and Frequent Transit



Net density: 30-50 dwellings per hectare



Net density: 20-40 dwellings per hectare



Net density: 45-65 dwellings per hectare

## Rotokauri

Low-medium residential supported by Town Centre and access to Rapid and Frequent Transit



Commercial and retail development



Net density: 30-40 dwellings per hectare



Net density: 30-40 dwellings per hectare

# Visualising indicative density and development - Central Corridor

## Frankton

Mixed use medium-high density, close vicinity to Town Centre. Serviced by H2A, Rapid and Frequent Transit



Net density: 60-70 dwellings per hectare

## Hamilton CBD

Walkable mixed use high density buildings combined with public spaces. Serviced by Rapid and Frequent Transit



Net density: 150-200 dwellings per hectare

## Hospital

Employment provided by Hospital, supported by mixed use medium density and Specialised Centre.



Net density: 55-65 dwellings per hectare

## Ruakura

Medium density housing serviced by Town/Business Centre comprising freight hub and access to Rapid Transit



Mixed-use commercial and public realm

## University

Medium density accommodation to support University. Serviced by Specialised Centre and Frequent Transit



Commercial and business development



Mixed-use and public realm



Net density: 20-100 dwellings per hectare



Mixed-use and commercial development



Net density: 45-55 dwellings per hectare



Net density: 35-45 dwellings per hectare



Retail and mixed-use development



Mixed-use and public realm



Retail area and public realm



Net density: 40-45 dwellings per hectare



Net density: 35-45 dwellings per hectare

# Visualising indicative density and development - Eastern Corridor

## HT1

Localised greenfield area at medium-low density with access to Town Centre and Frequent Transit



Retail and commercial development

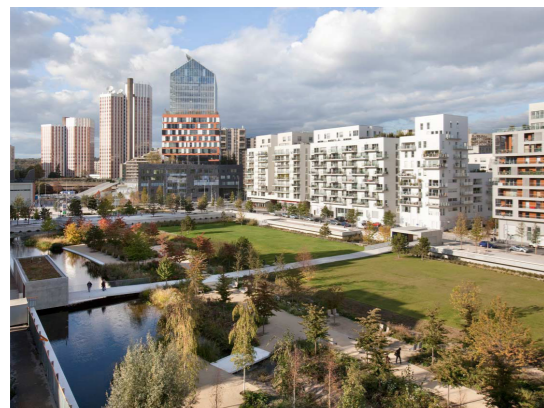

Mixed-use and public realm



Net density: 30-40 dwellings per hectare

## R2

Localised greenfield area at medium-low density with access to Town Centre and Frequent Transit



Net density: 40-50 dwellings per hectare



Commercial and public realm



Net density: 30-40 dwellings per hectare

## Chartwell

Metro Centre accompanied by medium density residential with access to Frequent Transit



Net density: 40-50 dwellings per hectare



Mixed-use and retail



Net density: 35-45 dwellings per hectare

## Fairfield

Medium density residential area serviced by Frequent Transit



Net density: 40-50 dwellings per hectare



Net density: 30-40 dwellings per hectare



Net density: 30-40 dwellings per hectare

# Visualising indicative density and development - Southern Corridor

## Peacocke

Localised greenfield area at medium-low density with access to Town Centre and Frequent Transit



Mixed-use and retail development



Net density: 35-45 dwellings per hectare



Net density: 35-45 dwellings per hectare

## Airport

Airport business park to be primarily a Business Centre and serviced by Frequent Transit



Business Park



Business Park



Business Park

## Te Awamutu

Medium density residential serviced by Metro Centre and Frequent Transit



Net density: 25-35 dwellings per hectare



Net density: 20-35 dwellings per hectare



Mixed-use and retail development

## Cambridge / Hautapu

Medium density residential serviced by Metro Centre and Frequent Transit



Net density: 25-35 dwellings per hectare



Net density: 20-30 dwellings per hectare



Net density: 20-35 dwellings per hectare